

250A CCS2 Vehicle Inlet Technical Parameters

SCZ-250A-1000V-EU-G002



Vehicle charging inlet for charging with direct current (DC), compatible with type 2 CCS vehicle charging connectors (EVSE), for installation in electric vehicles (EV).

EV charging inlet, for charging with alternating current (AC) and with direct current (DC), CCS type 2, IEC 62196.3-2022, 250 A / 1000 V (DC), 32 A / 480 V (AC), wires length: customize, locking actuator: 12V / 24V, Rear mounting, Push-on protective cap.

Dimension Drawing

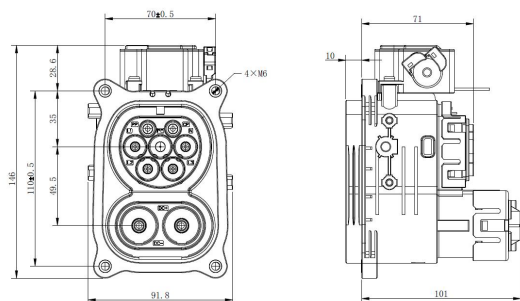

Product Characteristics

- The direct plug dust cover is made of TPU material, which has both hardness and toughness;
- Adopt unique drainage structure and one-piece plastic structure design to improve locking reliability;
- Bolt-free design, simple assembly process;
- The temperature sensor is close to the power terminal, with high sensitivity, accuracy and reliability;
- Using ultrasonic welding technology, low temperature rise and strong stability;
- Developed in accordance with IATF 16949 automotive standard, complies with IEC 62196-2022;

The Product Definition

Standard	IEC 62196-2022
Charging Standard	CCS type 2
Locking Type	Locking in the inserted state with a locking mechanism
Current Type	DC
Application	Charging inlet for new energy vehicles

Ambient Condition

Ambient Temperature (working)	-40 ~ +50°C
Degree of protection	IP44
Salt spray level	96H

Material specifications

shell Material	PA
Insulator Material	PA
Seal Material	silicone rubber
Pin Material	Copper Alloy, Silver Plated

Electrical Properties

Connection method	Ultrasonic welding, cannot be disconnected
Rated Current	DC+/DC-: 250A; L1/L2/L3/N: 32A ; PP/CP: 2A
Rated Voltage	DC+/DC-: 1000V DC; L1/L2/L3/N: 480V AC; PP/CP: 30V DC
Insulation resistance	100M (normal temperature) under 1000V DC
Temperature Monitor	2*PT1000
Electronic lock	12V / 24V DC

Cable Specifications

DC+/DC-	95mm ² , insulation outer diameter.: 17.3±0.3
PE	25mm ² , insulation outer diameter.: 9.6±0.3
L1/L2/L3/N	6mm ² , insulation outer diameter.: 4.7±0.2
PP/CP	0.75mm ² , insulation outer diameter.: 1.75±0.1
Thermal sensor/Electronic lock	0.5mm ² , insulation outer diameter.: 1.6±0.1

Mechanical Performance

Insertion/withdrawal cycle	>10000 times
Insertion& Pullout Force	<100N